

ISOPON[®] P.40[®]

BODY REPAIR KIT FOR HOLES

This **ISOPON** Body Repair Kit for Holes contains everything you need to repair and prime rust holes in most types of metal. First fill the hole using **P.40** Body Filler for Holes. It's easy to mix and can be used with aluminium mesh to bridge holes up to 75mm in diameter. Complete the repair with a layer of **P.38** Multi-Purpose Body Filler which can be easily sanded and then primed with the Multi-Purpose Primer aerosol. This sprays on easily and dries fast leaving a smooth, even finish that's ready to paint. Just follow the simple instructions in this guide for a quick and easy repair.

How much will this repair?

The contents of this kit are sufficient to repair approximately 4 holes up to 50mm in diameter.



Visit www.isopon.us.aus for a step-by-step video demo showing you how easy it is to achieve a perfect repair every time.

U-POL AUSTRALIA PTY LTD. UNIT A, 16 - 20 CASSOLA PLACE,
PENRITH, NSW 2750. AUSTRALIA

TELEPHONE: 02 4731 2655 EMERGENCY TEL: +61 290 372 994

E: INFO@U-POL.COM.AU W: WWW.U-POL.COM.AU

U-POL NZ LTD, C/O LINDSAY & ASSOCIATES, UNIT H, 12 AMERA PLACE,
EAST TAMAKI, AUCKLAND

TEL: 027 630 3691 EMERGENCY TEL: 0800 764 766

U-POL and ISOPON are registered trademarks of U-POL Ltd.

© 2017 Made in UK.

ISOPON[®]

BODY REPAIR KIT FOR HOLES

**STEP-BY-STEP
REPAIR GUIDE**

P.40[®]

STEP 1 - PREPARATION

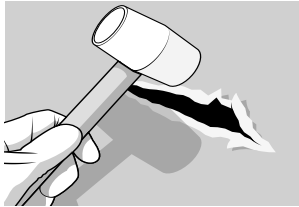

1. Wearing gloves provided, grind away or cut out any rust and hammer back any sharp edges of the damaged area.

2. Remove any paint from the damaged area and approximately 25mm around it with the coarse (80 grit) sandpaper and roughen the bare metal or surface.

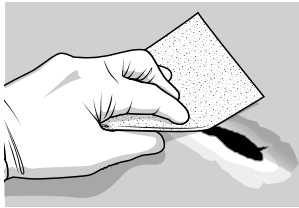

3. Wipe away loose particles and remove any grease with a solvent wipe. The area should now be clean, dry and free from loose paint, rust, dirt and grease.

STEP 2 - MIXING AND APPLICATION

BRIDGING WITH P.40 BODY FILLER FOR HOLES:

4. Remove cap from **P.40** Body Filler for Holes tube and pierce opening. Remove all **P.40** Body Filler for Holes from one tube onto a mixing sheet and squeeze out hardener to length **B**.

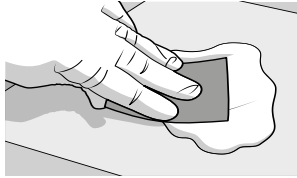

5. Using the applicator provided, mix the **P.40** filler and hardener together until you get a uniform colour. Thorough mixing is important to ensure best results. Apply to hole within 4 minutes of starting to mix.

6a. FOR SMALLER HOLES LESS THAN 25MM WIDE.

Apply the **P.40** filler in one layer so the final surface is not quite flush with the surface.

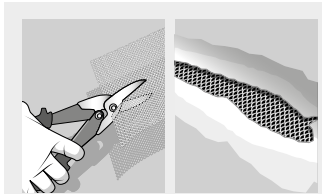

6b. FOR LARGER HOLES OVER 25MM WIDE.

Cut a piece of aluminium mesh 25mm larger than the hole before mixing the **P.40** filler to affix the mesh to the underside of the repair.

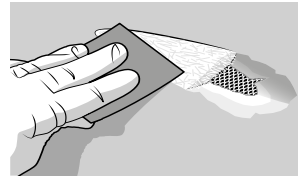

7. When set, mix up more Body Filler for Holes and apply a layer to cover the mesh (including the clean, dry metal around it). Allow to dry for 20-30 minutes.

8. When dry, you will effectively have a mesh plate that is 'welded' to the underside of the repair. The indentation and surface of the prepared area can now be filled with **P.38** Filler.

FINISHING WITH P.38 MULTI-PURPOSE BODY FILLER:

9. Cut open **P.38** filler sachet. Remove all **P.38** Multi-Purpose Body Filler from one sachet onto a mixing sheet and squeeze out hardener to length **A**.

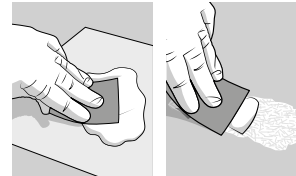

10. Using the applicator provided, mix the **P.38** filler and hardener together until you get a uniform colour. Thorough mixing is important to ensure best results. Apply to repair within 4 minutes of starting to mix.

11. Apply the filler in one layer so the final surface is slightly proud of the level required.

12. Allow to dry for 20-30 minutes prior to sanding.

STEP 3 - SANDING

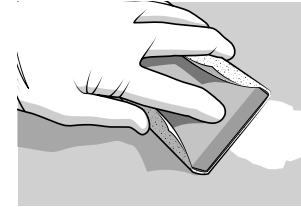

13. Using a sanding block with the medium (180 grit) sandpaper, carefully remove excess paste. Finish sanding with the fine (500 grit) sandpaper.

14. The final finish should be perfectly smooth and blend evenly with the surrounding area. Any small dents or depressions should be filled again with a small amount of paste and resanded.

15. When fully dry, clean area with wipe provided and use tack cloth to remove fine dust.

STEP 4 - PRIMING

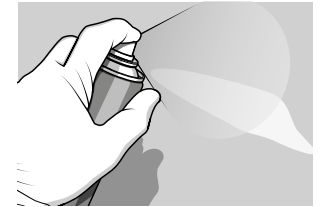

16. Apply Multi-Purpose Primer spraying 250-300mm away from repair. Apply two even coats covering 50mm larger than repair (covering any bare metal) and allow to dry for 10 minutes between coats.

Your repair is now ready to finish with your chosen topcoat. Once your chosen topcoat is dry, use **ISOPON** Clearcoat for a beautiful protective finish.